

1

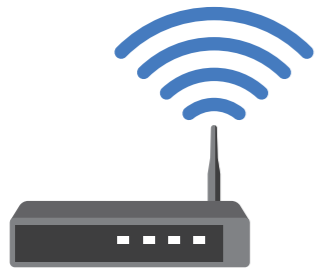

2



3

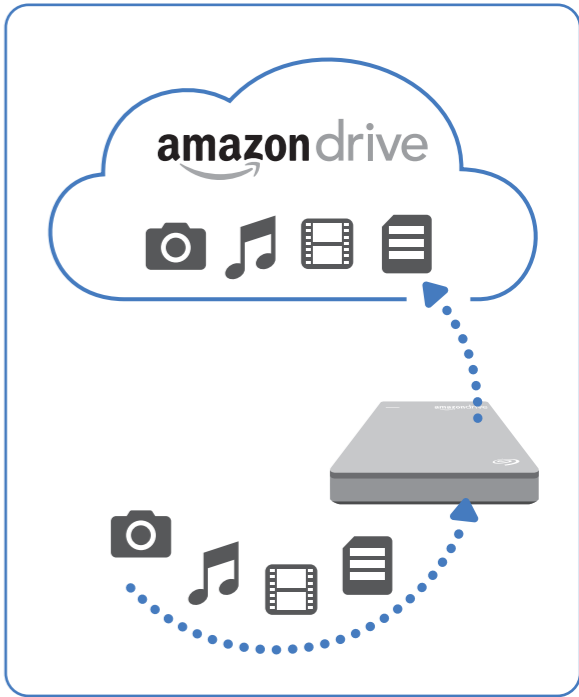
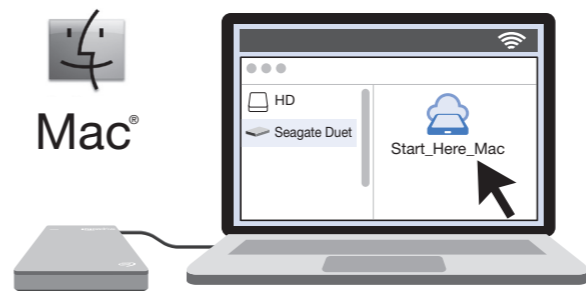
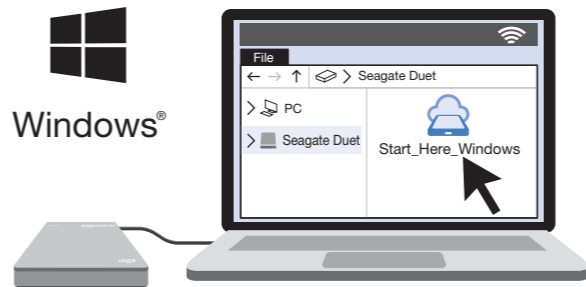

www.seagate.com/support/duet

WWW.SEAGATE.COM

Your PC/Mac requires an Internet connection using Wi-Fi or an Ethernet cable to access Amazon Drive.

Note: The Amazon Drive service may not be available in all areas. For assistance with the Amazon Drive service, please go to <http://www.amazon.com/help/amazondrive>.

Note: To protect your data, always follow the safe removal procedures for your operating system when disconnecting your product.

More information regarding Amazon Drive services is available at www.amazon.com/drive.

For customer support, visit www.seagate.com/support/duet.

To maximize performance, connect your drive to a USB 3.0 port. Also compatible with USB 2.0.

To review the details of your drive's warranty, open the Seagate Retail Limited Warranty Statement on your drive or go to www.seagate.com/retailwarranty. To request warranty service, get information regarding customer support within your jurisdiction, or to obtain information regarding the location of authorized Seagate service centers go to www.seagate.com.

FCC DECLARATION OF CONFORMANCE

This device complies with Part 15 of the FCC Rules. Operation is subject to the following two conditions: (1) this device may not cause harmful interference, and (2) this device must accept any interference received, including interference that may cause undesired operation.

CLASS B

This equipment has been tested and found to comply with the limits for a Class B digital device, pursuant to Part 15 of the FCC Rules. These limits are designed to provide reasonable protection against harmful interference in residential installation. This equipment generates, uses,

and can radiate radio frequency energy and, if not installed and used in accordance with the instructions, may cause harmful interference to radio communications.

However, there is no guarantee that interference will not occur in a particular installation. If this equipment does cause harmful interference to radio or television reception, which can be determined by turning the equipment off and on, the user is encouraged to try to correct the interference by one or more of the following measures:

- Reorient or relocate the receiving antenna.
- Increase the separation between the equipment and receiver.
- Connect the equipment into an outlet on a circuit different from that to which the receiver is connected.
- Consult the dealer or an experienced radio/TV technician for help.

CAUTION: Any changes or modifications made to this equipment may void the user's authority to operate this equipment.



amazon drive

SEAGATE

© 2016 Seagate Technology LLC. All rights reserved. Seagate, Seagate Technology and the Spiral logo are trademarks or registered trademarks of Seagate Technology LLC, or one of its affiliated companies in the United States and/or other countries. Amazon and all related logos are trademarks of Amazon.com, Inc. or its affiliates. All other trademarks or registered trademarks are the property of their respective owners. Seagate reserves the right to change, without notice, product offerings or specifications. Complying with all applicable copyright laws is the responsibility of the user.

Seagate Technology LLC
10200 S. De Anza Blvd.
Cupertino, CA 95014
U.S.A.

Seagate Singapore International
Headquarters Pte. Ltd.
Koolhovenlaan 1
1119 NB Schiphol-Rijk
The Netherlands

PN: 100810600B 11/16

SEAGATE

Duet

Cloud-Syncing
Portable Hard Drive

QUICK START GUIDE



100810600B